

**First Floor**  
TUSCAN EXTERIOR DESIGN SHOWN

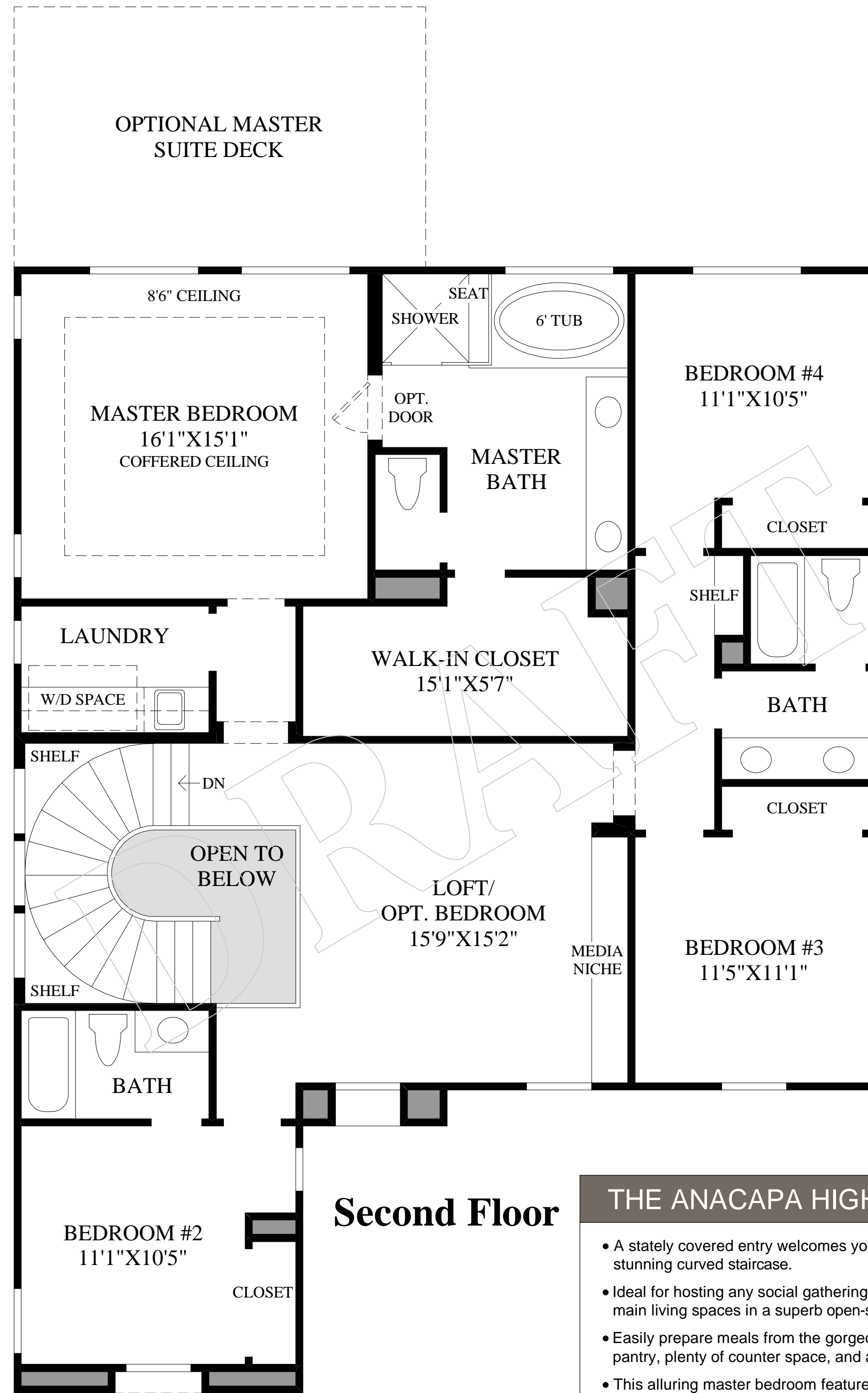

SPANISH COLONIAL AND ITALIANTE EXTERIOR DESIGNS INCLUDE LARGER DECORATIVE BALCONY.

**THE ANACAPA HIGHLIGHTS**

- A stately covered entry welcomes you to the elegant foyer which showcases a stunning curved staircase.
- Ideal for hosting any social gathering, this beautifully designed home unifies the main living spaces in a superb open-scheme layout.
- Easily prepare meals from the gorgeous kitchen which boasts an appealing walk-in pantry, plenty of counter space, and a large center island with a breakfast bar.
- This alluring master bedroom features a tasteful coffered ceiling and a stylish master bath that includes a large soaking tub, a separate shower, and a walk-in closet.
- Centrally located to the upstairs bedrooms is a sensational loft that provides a supplemental living space that makes for easy multi-generation entertaining.
- Also included is an elaborate sliding door system that opens up the home to a generous luxury outdoor living space.