

First Floor

SPANISH COLONIAL EXTERIOR DESIGN SHOWN

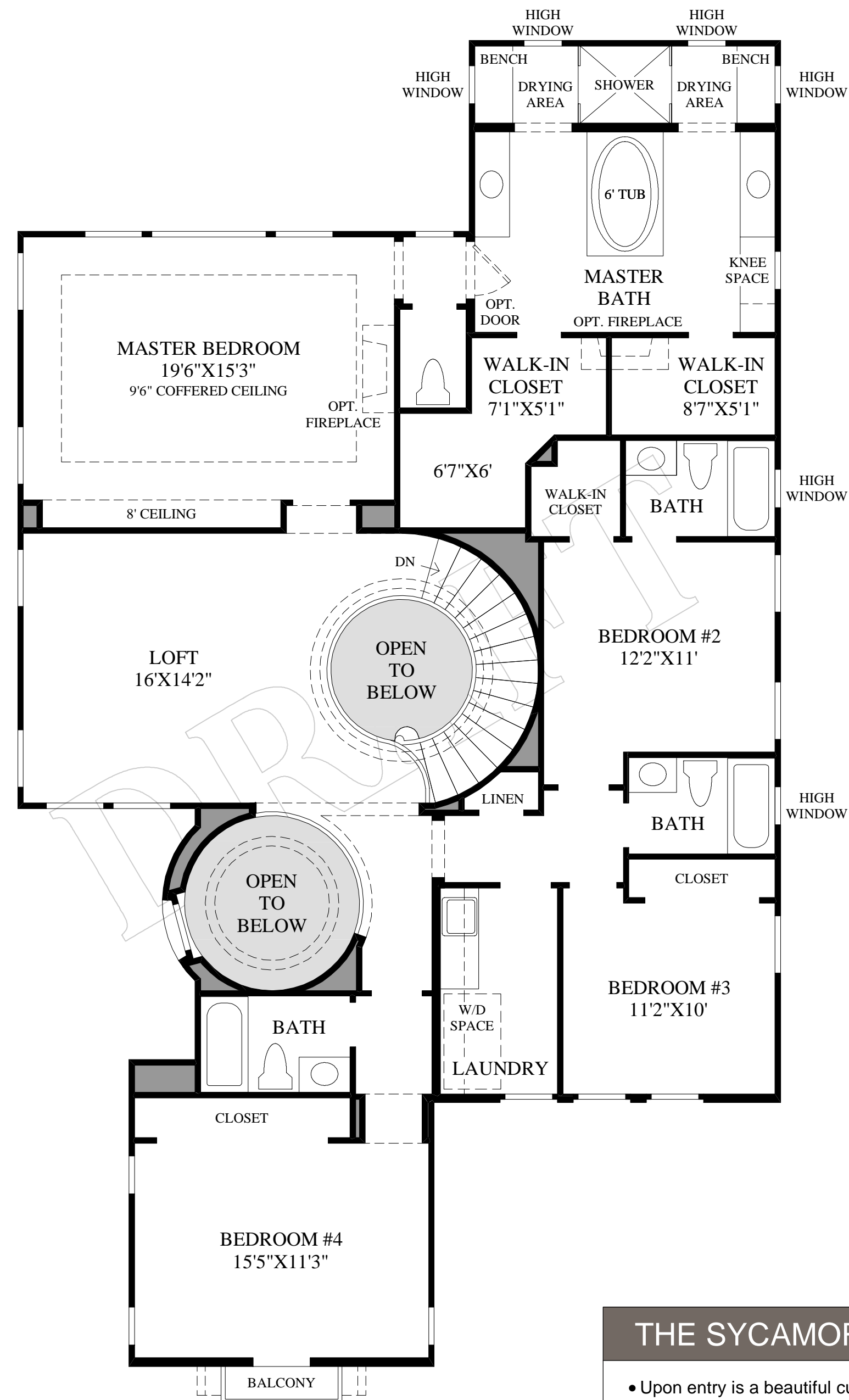

Second Floor

TUSCAN AND ANDALUSIAN EXTERIOR DESIGNS INCLUDE ALTERNATE BALCONY CONFIGURATION.

THE SYCAMORE HIGHLIGHTS

- Upon entry is a beautiful curved foyer that flaunts a double-volume ceiling and leads to a stunning curved staircase.
- Ideal for entertaining, the open floor plan features a large great room that includes a access to the luxury outdoor living space.
- The stylish kitchen flaunts a center island with a curved breakfast bar, a walk-in pantry, plenty of counter space, and an accompanying dining room that has superb views towards the rear yard.
- This master bedroom showcases a coffered ceiling, an impressive array of windows, and a luxurious master bath that offers a 6' soaking tub and a shower flanked by convenient drying areas with benches.
- Additional highlights include large secondary bedrooms, a well-placed laundry room, an appealing office, and a desirable loft.